



West Virginia Strawberry Festival Association, Inc.
P.O. Box 117
Buckhannon, WV 26201
(304) 472-9036 (o)
(304) 472-9037 (f)

Band Handbook &
Important Information



Table of Contents

<i>General Information</i>	<i>page 3 - 14</i>
Band Coordinator Letter	Emergency Squad Information
Important Telephone Numbers	Lodging Options
Competition Schedule	Publicity Form*
Miscellaneous Notes and Check List	Participation Form (two pages)*
WV Wesleyan Scholarship Information	Parade Policies Form*
<i>Parade Competition</i>	<i>page 15 - 22</i>
General Information	
Parade Route	
Adjudication Forms	
<i>Concert Competition</i>	<i>page 23 - 27</i>
General Information	
Concert Competition Program Form*	
Adjudication Form	
<i>Jazz/Stage Competition</i>	<i>page 28 - 32</i>
General Information	
Jazz/Stage Competition Program Form*	
Adjudication Form	

NOTE: All items with (*) must be returned to the Strawberry Festival office before April 1st.





Dear Director(s):

Welcome to the West Virginia Strawberry Festival! We hope you and your students enjoy this annual celebration, which is one of the largest of its type in the Eastern United States. Your group will be seen by 100,000 live spectators in Buckhannon and a large television audience of approximately 450,000 with our live coverage of the Grand Feature Parade.

We have compiled this informational handbook in an effort to make your visit with us well organized and worthwhile. To help us be better organized, please mark the following deadlines on your calendar.

April 1st: All application forms and checks must be mailed so your organization is assured a competition slot in our schedule of events. This is the last date for making changes in your schedules. All classifications for band competitions must be final!

We must have each band in the proper class for the parade competition. Classification is determined by the number of instrumental members in your band and is explained later in the handbook. Bands may move up in classification for parade, if so desired.

You will find in this handbook the following:

- General Festival Information about all competitions
- Award Summary
- West Virginia Wesleyan Campus Map
- Parade Route Information and Diagram

A brief reminder with some important last minute information will be mailed the week before the festival. Again, we are looking forward to your participation in this year's annual festival.

Sincerely,

Grand Feature Parade Director
Phone: 304-472-9310





P.O. Box 117 • Buckhannon, WV 26201 • 304-472-9036 • Fax 304-472-9037 • www.wvstrawberryfestival.com

IMPORTANT TELEPHONE NUMBERS

Band/Unit Coordinator	304-472-1545
Grand Feature Parade Director	304-472-9310
Buckhannon Fire Department	304-472-2868
WV Strawberry Festival Office	304-472-9036
Buckhannon City Police	304-472-5723
Upshur County Sheriff	304-472-1180
St. Joseph's Hospital	304-473-2000
West Virginia Wesleyan College	304-473-8000
Visitor Center	304-473-1400
Housing and Meals Coordinator	304-473-8112
Local Emergencies	911



West Virginia Strawberry Festival Band Competition Schedule

THURSDAY

Junior Royalty Parade 6:30 p.m.

FRIDAY

Concert Band Competition 9:00 a.m. – 5:00 p.m.
Location: WWC Performing Arts Center

Jazz/Stage Band Competition 9:00 a.m. – 5:00 p.m.
Location: WWC Loar Auditorium- WWC

Firemans' Parade 6:30 p.m.
NO COMPETITION (open to all visiting bands)
Orchestra Competition
Location: Wesley Chapel-WWC

SATURDAY

Grand Feature Parade 1:00 p.m.
Competition for all visiting bands

Field Exhibition 5:00 p.m.
at West Virginia Wesleyan College, Ross Field



Important Notes

There will be a Grand Feature Parade on Saturday regardless of weather conditions. There will be an estimated 100,000 spectators lining the parade route and an additional 450,000 viewers by our live television broadcast.

All bands which will be eating meals in Buckhannon are asked to eat together as one unit. This will make it easier for both the organizations serving the food as well as the band directors or boosters paying for meals.

All bands should report to the Festival Headquarters on Main Street upon arrival to the festival city. Please be sure you have advised the band coordinators of your arrival time. All buses should take the Buckhannon / Route 20 exit off Route 33 – Robert C. Byrd Highway.

Escorts will meet bands throughout the week. These escorts will be briefed on your particular band and its schedule prior to your arrival. Therefore they should be able to answer most questions the band might have.

KEEP WITH YOUR SCHEDULE!!! If your band is scheduled for a certain event, your band is expected to be there.

It is important to carefully check all parade, concert, jazz, and field exhibition rules in order to guarantee that you will not be in violation during your competitions.

Please note that all units must continue to march and not stop for performances during the Grand Feature Parade. Failure to comply with this rule will result in **automatic disqualification.**

Awards will be awarded at Wesley Chapel-WWC Campus, approximately one (1) hour following the completion of the Junior Royalty Parade and at Wesley Chapel on the campus of WV Wesleyan College after the Grand Feature Parade. Each band is expected to have a representative present to accept their awards.



Parade Times are as follows:

Thursday 6:30 p.m. – Junior Royalty Parade
Friday 6:30 p.m. – Fireman’s Parade
Saturday 1:00 p.m. – Grand Feature Parade

Medical Permits should be carried in all parades.

If possible, all bands participating in the Grand Feature Parade should try to arrive in Buckhannon on Saturday morning by no later than 10:00 a.m.

Upon check-in at the Festival Headquarters all bands will be given bus numbers and parking locations. Parking location will announced at a later date.

YOUR BAND ESCORT WILL DIRECT YOU TO YOUR DESIGNATED PARKING AREA!

A final schedule will be mailed to your band prior to festival week.

Bus parking area numbers will also be mailed and must be placed in the front window of each bus.



West Virginia Strawberry Festival CHECK LIST

If any of the following items have not been completed either by the Band Director or Festival Official, please contact the Parade Director at (304) 472-9310 or leave a message. We will return your call.

- Have the proper forms and payments been mailed to the Strawberry Festival Office by the April 1st deadline? These forms include: Participation Information Forms, Publicity Forms with photo and the Policies Form?
- Have your lodging arrangements been taken care of? (This should include lodging for students, directors, boosters and bus drivers.)
- Have you taken care of dining arrangements?
- Have news releases reached your area concerning the festival?

These items must be taken care of in order to make your band's trip to the West Virginia Strawberry Festival an enjoyable, educational and successful trip.

**All items are to be mailed by April 1st to: WVSF Grand Feature Parade Bands
PO Box 117
Buckhannon WV 26201**

Questions? Call 304-472-9310



UPSHUR COUNTY EMERGENCY SQUAD

P.O. Box 124
Buckhannon, WV 26201

Visiting Bands and Marching Units:

Welcome from the Upshur County Emergency Squad! While participating in the Strawberry Festival activities, we would like to remind you that if our services are needed the emergency number in Upshur County is 911. We provide advanced emergency care with EMT's and Paramedics staffing our units. You are welcome to stop by the Emergency Squad Headquarters on the corner of Pocahontas and Preston Street in Buckhannon.

During the Strawberry Festival, Emergency first aid stations will be set up in strategic areas along the parade route during the Grand Feature Parade on Saturday.

Due to the length of the parade and the time of year, most of our patient care is heat related. Remember not to eat a great deal of food and try to stay away from sweet drinks while marching. Also, due to the age of the band students, parent consent forms will be needed to treat and transport.

Once again, Welcome to Buckhannon and the West Virginia Strawberry Festival!

Sincerely,

Upshur County Emergency Squad



West Virginia Strawberry Festival Lodging Options

(WV Wesleyan College is the recommended housing option**)

Buckhannon

WV Wesleyan College**	59 College Avenue	304-473-8104
A Governor's Inn B&B	76 E. Main St.	304-472-2516
Baxa Motel	21 N. Kanawha St.	304-472-2500
Bi-Centennial Motel	88 E. Main Street	304-472-5000 / 800-762-5137
Centennial Motel	22 N. Locust St.	304-472-4100
Colonial Motel	24 N. Kanawha St.	304-472-3000 / 800-209-8140
Hampton Inn	1 Commerce Blvd.	304-473-0900 / 800-426-7866
Microtel Inn	2 North Ridge Dr.	304-460-2525

Weston (approx. 15 min from Festival)

Comfort Inn	I-79 Exit 99 (Rt. 33)	304-269-7000
Holiday Inn Express	215 Staunton Dr.	304-269-3550
Stonewall Jackson Resort	I-79 Exit 91	304-269-7400
Super-8	I-79 Exit 99 (Rt. 33)	304-269-1086
Weston Motor Inn	Rt. 19 South	304-269-1975
Wilderness Plantation Inn	I-79 Exit 105	304-884-7806
Jackson's Mill Conference Center	Weston, WV	800-287-8206

Elkins (approx. 20 min from Festival)

Best Western of Elkins	Beverly Four Lane Rt. 219 & Rt. 250 S	304-636-7711 / 800-528-1234
Econo Lodge	Rt. 33	304-636-5311 / 800-446-6900
Cheat River Lodge	Rt. 33 East	304-636-2301
Elkins Motor Lodge	Harrison Ave.	304-636-1400
Holiday Inn Express	50 Martin Street	304-630-2266 / 877-863-4780
Super-8	Rt. 219 South	304-636-6500 / 800-800-8000

Clarksburg (approx. 35 min. from Festival)

Ramada Limited	Rt. 50 East – 250 Emily Dr.	304-623-2600
Day's Inn	Rt. 50 East & I-79 Exit 119	304-842-7371 / 800-325-2525
Econo Lodge	I-79 Exit 121 Meadowbrook Rd.	304-842-7381
Greenbrier Motel & Restaurant	Rt. 20 South	304-624-5518
Hampton Inn	I-79, Exit 121	304-842-9300
Comfort Inn	Rt. 50 East & I-79 Exit 119	304-623-2600
Red Carpet Inn	Rt. 50 East & I-79 Exit 119	304-842-7371
Holiday Inn	Rt. 50 East & I-79 Exit 119	304-842-5411
Marriot	Rt. 50 East & I-79 Exit 119	
Terrace Motel	Rt. 50 East & I-79 Exit 119	304-622-6161



West Virginia Strawberry Festival

Band Participation Information Form

Name of School: _____

Director (s): _____

City: _____ State: _____ Zip: _____

School Phone: _____ Website: _____

Fax Number: _____ E-Mail: _____

In addition to the regular schedule of activities that we plan to participate in, we would like for you to arrange these additional activities.

Additional Field Rehearsal Stand Up Concert Other _____

Please list the authorized state agency and /or accreditation organization that lists your school as having met approved standards. _____

CONCERT COMPETITION

We will compete in Concert Competition. **ENTRY FEE \$125.00**

Entry Fee is: Enclosed Will Follow

Competition Class: AAA AA A Jr. High / Middle School

JAZZ / STAGE COMPETITION

We will compete in Jazz / Stage Band Competition **ENTRY FEE \$125.00**

Entry Fee is: Enclosed Will Follow



PARADE COMPETITION

We will participate in the following parades: (check all that apply)

- Junior Royalty Parade: Thursday 6:30 PM
- Fireman’s Parade: Friday 6:30 PM
- Grand Feature Parade: Saturday 1:00 PM

We will march the following number of band members:

_____	Majorettes	_____	Drum Majors	_____	Color Guard
_____	Flags or Silks	_____	Rifles	_____	Musicians

We will compete in the following classification:

- | | |
|--|---|
| <input type="checkbox"/> Class AAA High School
90 plus (Including Percussion) | <input type="checkbox"/> Class AA High School
56-90 (Including Percussion) |
| <input type="checkbox"/> Class A High School
0-55 (Including Percussion) | <input type="checkbox"/> Class B Jr. High / Middle School |

**Please return this form by April 1st to: WVSF Bands
PO Box 117
Buckhannon, WV 26201**



West Virginia Strawberry Festival BAND APPLICATION / PUBLICITY FORM

Name of Band _____

City _____ State _____

Director (s) _____

Uniform Colors _____

Total Marching Unit _____ Majorette Unit _____

Drum Majors _____

Distance Traveled _____ Cost of Trip _____

How did you raise the money? _____

Recent Honors _____

News Release – Name of Newspaper _____

Address _____

Other Important Information _____

Please include a photo of your group with the form. This information is very important for local publicity and programs. Please return this form by **April 1st** to: WVSFA Bands / PO Box 117 / Buckhannon, WV 26201



WV Strawberry Festival Parade Policies Form

I/we agree to meet the following standards and requirements set by the WV Strawberry Festival. Should these requirements not be met to the satisfaction of the Parade Committee, I/we understand that the Committee reserves the right to withdraw acceptance of the unit at any time up to AND including the day of the Parade.

1. I/we accept that all audio-visual equipment and transportation used during the parade (i.e., vehicles, golf carts, etc.) will be fully concealed and / or decorated to be aesthetically appealing to spectators. I/we agree that no other vehicles (e.g., supply trucks, dignitary cars) will accompany our group down the Parade route. Any trucks, vehicles, etc. that are determined to not be properly decorated by the parade Committee up to and including the day of the Parade, will not be allowed on the route.
2. The specialty / auxiliary unit will NOT interrupt the flow of the Parade. If the unit does not move at a steady pace down the route an Official Festival Representative has the authority to remove the unit from the Parade.
3. Persons not performing with the group, shall not march behind the band and may walk on the sidewalks along the parade route. Approval by the Parade Committee may be granted for extenuating circumstances that would warrant persons marching behind the band.
4. I/we will carry appropriate banners or signage to identify your unit. (NOTE: Signage should be professionally prepared and large enough for the television and live audiences to read easily.)
5. I/we will arrive at the Parade staging area at the designated time. (NOTE: Specific staging time and instructions will be mailed to all units.)
6. I/we will sign and return the information packages pertaining to our participation in this year's WV Strawberry Festival. (NOTE: The information will be used for advertising and television coverage purposes.)

Signed: _____ Date: _____

Title: _____ Phone: _____

In agreement for (Name of Unit): _____

Please return this form by April 1st to: WVSFA Bands / PO Box 117 / Buckhannon, WV 26201



PARADE COMPETITION

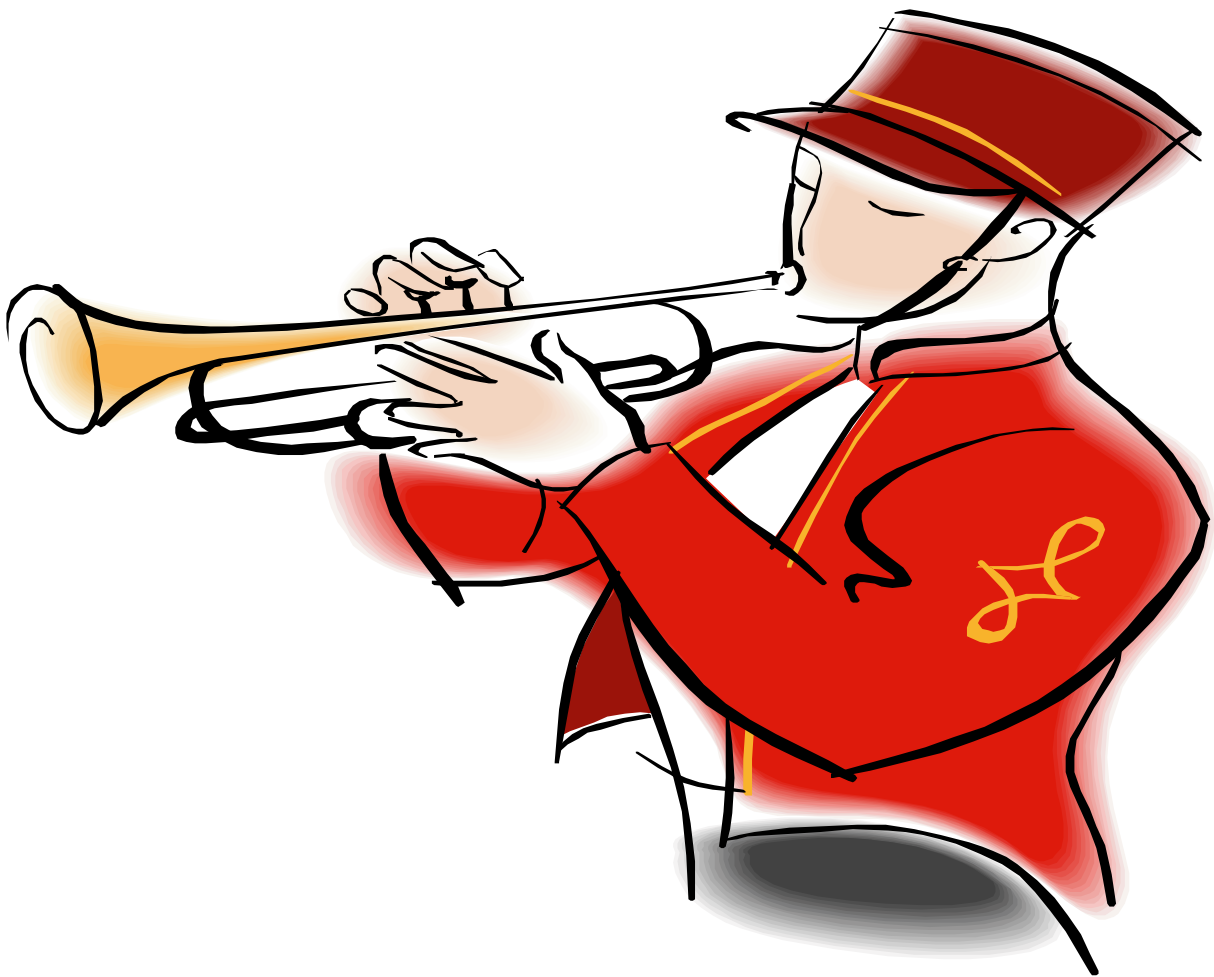



West Virginia Strawberry Festival Parades

Junior Royalty Parade	Fireman's Parade	Grand Feature Parade
Thursday	Friday	Saturday
6:30 p.m.	6:30 p.m.	1:00 p.m.

PARADE ROUTE for each parade is the same. The length of the route is 2.5 miles. (See attached guide)

ASSEMBLY for each parade will be on Camden Avenue between Marion Street and West Virginia Wesleyan College ready to step onto Marion Street for the start of marching.

Assembly times are as follows:

- Junior Royalty Parade: 6:00 p.m.
- Fireman's Parade: 6:00 p.m.
- Grand Feature Parade: First Division – 12:00 noon, Second Division – 12:30 p.m., Third Division – 1:00 p.m., Fourth Division – 1:30 p.m.

THE PACE for each band should maintain forward motion at all times. **No band shall delay the forward progress of any of the parades in order to give a concert or any theatrical or military production.

CLASSIFICATION of bands for adjudication purposes will be as follows:

- Class "B": - Junior High School or Middle School Bands
- Class "A" – High School Bands with no more than 55 wind and percussion instrumentalists
- Class "AA" - High School Bands with not over 89 wind and percussion instrumentalists
- Class "AAA" – High School Bands with any number of wind and percussion instrumentalists 90 and above.

RESULTS of adjudication will be available on Thursday evening following the Junior Royalty Parade at the Upshur County Court House. Results and Awards for the Grand Feature Parade will be available at the awards presentation Saturday afternoon at Wesley Chapel.

NOTE: In the event of any clerical errors, the tabulator's sheet used at the Judge's Stand will be the final authority.



ADJUDICATION of bands will take place for the Junior Royalty Parade on Thursday and the Grand Feature Parade on Saturday. Only Junior High School Bands and Middle School Bands will be adjudicated on Thursday evening. All bands will be judged on Saturday.

JUDGES: A minimum of three (3) judges, all of whom shall be qualified to judge at the high school level or above, shall be employed by the West Virginia Strawberry Festival Association for the purpose of determining the awarding of prizes based on the performances of participating high school bands in the Grand Feature Parade. Judges decisions are final and not subject to change by any other officials.

JUDGING CATEGORIES are as follows:

- A) Overall band performance (music, marching, and appearance)
- B) Auxiliaries including twirling, flags, rifles, drum majors, majorettes and pom-poms.

GRAND FEATURE PARADE AWARDS: The top three (3) scores in each category for Junior High / Middle School and High School will be recognized from the Grand Feature Parade on Saturday. The Grand Champion trophy and prize money will recognize the top three (3) bands as ranked by the Grand Champion Score Sheet (Page 22).

***** (Winning the Grand Champion Award does not automatically make you the WV In-State Honor Band. At the discretion of the Parade Committee, an announcement will be made by November following the previous Festival.)**

ENTRY: To participate in the Grand Feature Parade each band must submit a paper copy of the Band Participation Information Form, Band Publicity Form and a signed copy of the Festival Parade Policies Form (all found on *pages 11-14* of this Handbook). All Entry Forms and payment must be submitted by April 1st. Entry Forms submitted after this deadline will result in the group being placed in the last division of the Parade.



West Virginia Strawberry Festival Parade Route

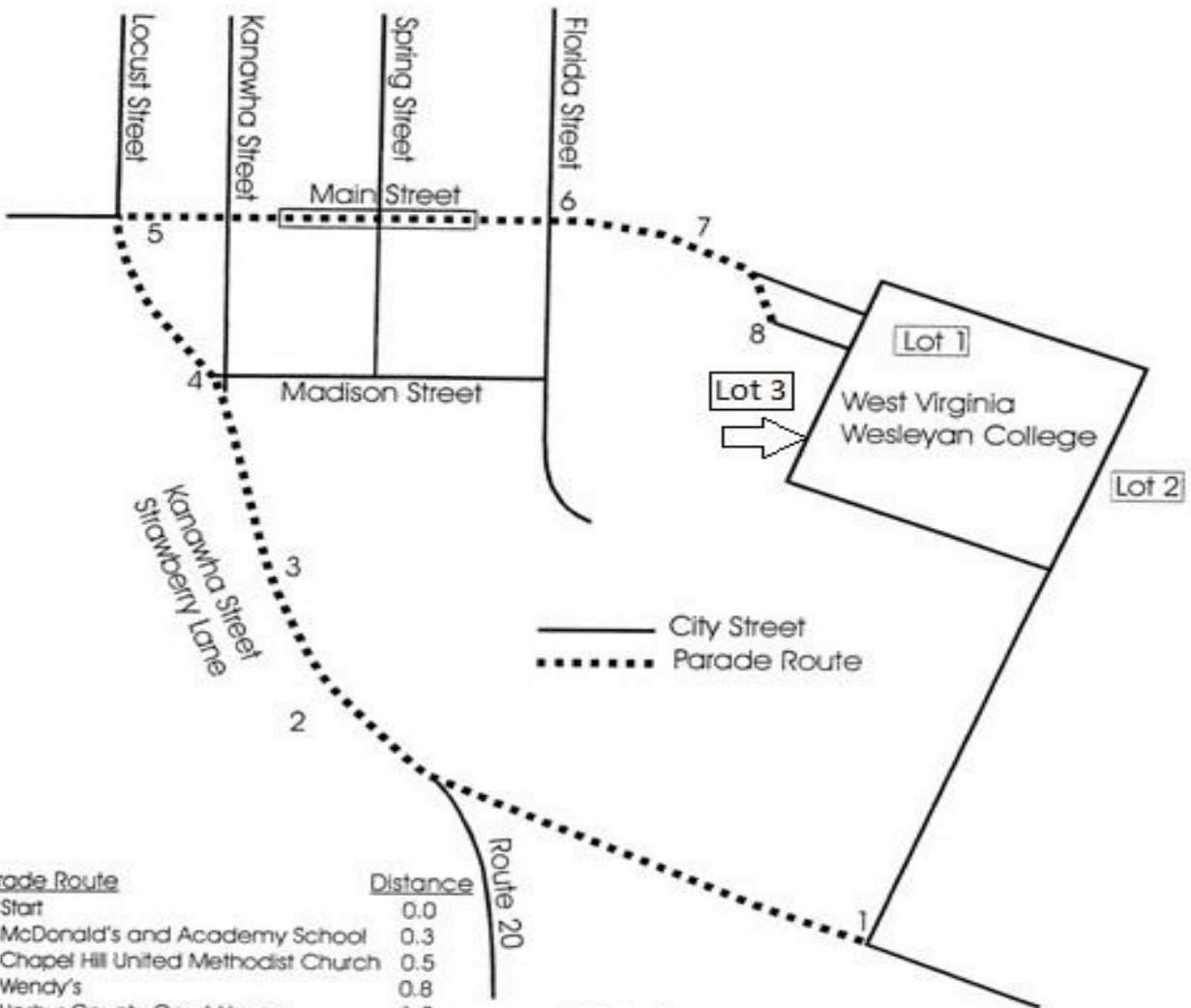

Parade Route	Distance
1. Start	0.0
2. McDonald's and Academy School	0.3
3. Chapel Hill United Methodist Church	0.5
4. Wendy's	0.8
5. Upshur County Court House	1.0
6. City Hall	1.2
7. BI-Centennial Hotel	1.3
8. Finish	1.4

Parking Areas
 Lot 1 & 2 - West Virginia Wesleyan College
 Lot 3 - Admin Loop - Wesleyan College



***Grand Feature Parade
Majorette***

Name _____ Class _____

Total Points Possible	Description	Score / Comments
25 Points	MARCHING & MANEUVERING Rank File Intervals Out of Step Formations	
25 Points	UNIFORMITY & PRECISION Performance Routine Difficulty	
25 Points	GENERAL EFFECT Originality Enthusiasm Audience Appeal Overall Performance	
25 Points	APPEARANCE Uniforms or Costumes	

TOTAL	
--------------	--

Judges' Comments:

Judge: _____



Grand Feature Parade
Drum Major

Name _____ Class _____

Consider the following:

- Conducting
- Overall Appearance
- Dignity/Posture
- Professionalism
- Showmanship
- Marching Style
- Audience Appeal
- Unique Positive Qualities

Judges' Comments: _____

Score: _____ (100 Point Max)

Judge: _____



***Grand Feature Parade
Auxiliary***

Name _____ Class _____

Total Points Possible	Description	Score / Comments
25 Points	MARCHING & MANEUVERING Rank File Intervals Out of Step Formations	
25 Points	UNIFORMITY & PRECISION Performance Routine Difficulty	
25 Points	GENERAL EFFECT Originality Enthusiasm Audience Appeal Overall Performance	
25 Points	APPEARANCE Uniforms or Costumes	
TOTAL SCORE:		

Judges' Comments: _____

Judge: _____



***Grand Feature Parade
Band***

Name _____ Class _____

Director _____ Division _____

Total Points Possible	Description	Score / Comments
30 Points	<u>GENERAL EFFECT</u> Variety & Complexity of Repertoire Phrasing and Expression Style and Idiomatic Interpretation Variety & Complexity of Visual Composition Audio Visual Coordination and Staging Auxiliary Contributions Percussion Contributions	
30 Points	<u>MARCHING TECHNIQUE</u> Uniformity of Marching Style or Method Upper Body Technique, Body Control & Instrument Carriage Spatial Relationships Alignment Relationships Posture, Presence and Professionalism	
40 Points	<u>MUSICAL TECHNIQUE</u> Attacks & Releases Rhythmic Accuracy Blend & Balance of all Sections Intonation Precision Tone Quality	
TOTAL SCORE:		

JUDGE'S COMMENTS: _____

JUDGE: _____



CONCERT COMPETITION

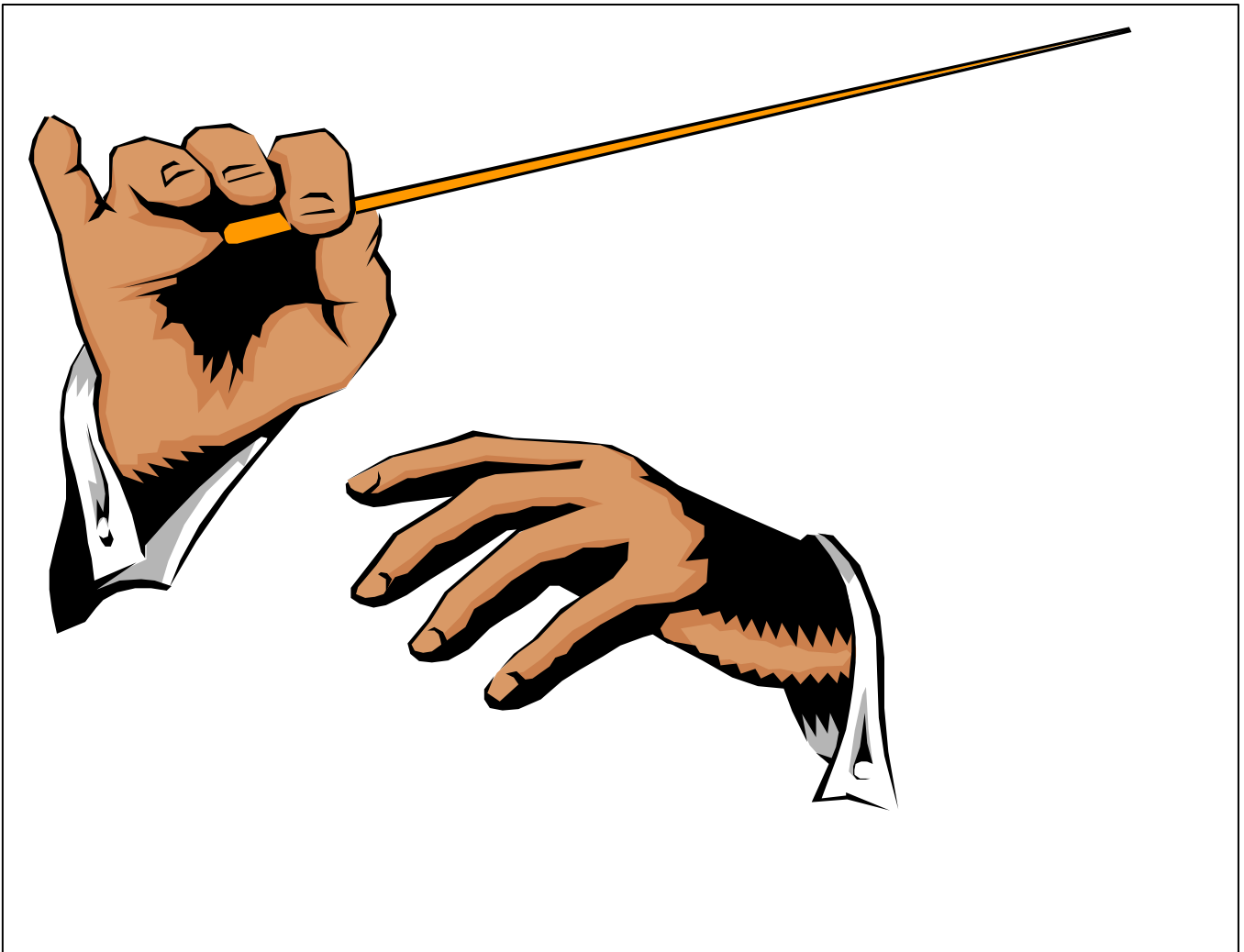



West Virginia Strawberry Festival High School Band Concert Competition

Date:	Friday
Time:	9:00 a.m. until 5:00 p.m.
Location:	WV Wesleyan College
Participants:	Groups will be limited to sixteen

DEFINITION: High School Concert Band shall be considered any size group of High School student musicians performing music on wind instruments and percussion instruments and led or directed without qualifying restrictions by any person.

CLASSIFICATION: There will be three levels of competition. Class, AAA, AA, and A. If scheduling permits, a limited number of bands may enter a second unit, which may enter as a Class B unit. Class B bands are exhibition bands and may perform for comment only.

ADJUDICATION TIMES: The contest will begin at 9:00 a.m.

MUSIC: A band is required to play two selections, both to be chosen by the director of the competing organization. The difficulty of the selection should be consistent with the contest classification that the band competes within.

- Class AAA should perform selections that in the majority of the Nation's published music lists is graded "Difficult" or "Grade Level VI"
- Class AA should perform selections that in the majority of the Nation's published music lists is graded either "Medium Difficult" and "Difficult" or "Grade Level V" and "Grade Level VI"
- Class A should perform selections that in the majority of the Nation's published music lists is graded either "Medium" and "Medium Difficult" or "Grade Level IV" or "Grade Level V"
- Class B should perform selections that in the majority of the Nation's published music lists is graded either "Medium Easy, Medium, Medium Difficult, Difficult" or "Grade Level III, IV, V, VI".

The performance of a warm up selection without qualification as to difficulty will be reflected on the score sheet under "Musical Selection".



WARM UP ROOM: Each band will be allowed no more than 30 minutes in the warm up room immediately before their adjudication time. No band will be allowed to use any of their warm up time on stage. Equipment in the warm up room will include 120 chairs, 60 musician's stands and a conductor's stand.

EQUIPMENT ON STAGE: For the use of each band, available equipment will include: Conductor's podium, Conductor's stand, 60 musician's stands, 120 chairs, concert bass drum, four timpani, orchestra bells, xylophone, gong, and chimes. Each band must furnish its own sticks, mallets, beaters, and additional percussion equipment required by their repertoire and not provided as listed above.

ADJUDICATION: The WV Strawberry Festival Band Adjudication Form is to be used by Judges. A sample copy is attached. To obtain the final score for a band in competition, the score of the three judges will be averaged.

AWARDS: Awards will be presented to the bands finishing first, second, and third in Class A, AA, and AAA.

Grand Champion Trophies will be awarded to the bands attaining the highest scored in the Concert Competition regardless of Classification competed within. (Class B Bands are not eligible for awards.)

Sweepstakes Grand Champion Trophies will be awarded to the bands finishing first, second, and third place in the highest cumulative points scored in concert, jazz/stage, and field and parade competition.

Sweepstakes Grand Champion: ONLY bands competing in all four competitions are eligible for Sweepstakes Grand Champion Awards. Presentation of awards for classification winners and Grand Champion winners will be made in the Rockefeller Gymnasium immediately following the conclusion of the day's concert and jazz programs.

ENTRY FEE: A non-refundable entry of \$125.00 is to be paid and returned with your festival application. Check should be made payable to the West Virginia Strawberry Festival.

*There is no entry fee for participation in any of the three parades.

ELIGIBILITY: Eligibility is limited to Concert Bands from any High School accredited by its authorized state agency or accreditation organization such as the North Central Association. All bands must include the agency on the application form.

TIEBREAKER: Tied scores involving two bands eligible for awards or trophies will be broken by consultation of the Judges.

CONDUCTOR'S SCORES: Each band must provide three conductor's scores for each of the two numbers that are submitted for adjudication. Every score must have the measures numbered consecutively. These scores will be returned at the conclusion of the event along with adjudicator's score sheets, tape comments, and tabulator's recap.

ADJUDICATION TIME: Entry fee must be received before adjudication time is assigned to your band. It is to your advantage that we receive your entry fee as soon as possible.



West Virginia Strawberry Festival Concert Band Competition Program Form

Dear Band Director: The following information will be used to prepare the program for the concert band competition. Typed responses would be preferred and try to limit your information to the space allowed.

Name of School: _____

City and State: _____

Director:			
Assistant Director:			
Principal:			
Number in performing group		School Enrollment:	

Recent Honors and Activities:

MUSIC SELECTIONS

Composer/Arranger	Title	Publisher
Warm Up _____	_____	_____
1. _____	_____	_____
2. _____	_____	_____



Concert Band Adjudication

School Name _____ Class _____

Director's Name _____ Size of Band _____

V – Poor 10.0 – 11.9	IV – Fair 12.0 – 13.9	III – Good 14.0 – 15.9	II – Excellent 16.0 – 17.9	I Superior 18.0 – 20.0	SCORE
-------------------------	--------------------------	---------------------------	-------------------------------	---------------------------	-------

- **Tone Quality and Intonation – 20 Possible Points**
 Blend Harmonic Structure Control Individuals Melodic Line Collective Quality

V – Poor 10.0 – 11.9	IV – Fair 12.0 – 13.9	III – Good 14.0 – 15.9	II – Excellent 16.0 – 17.9	I Superior 18.0 – 20.0	SCORE
-------------------------	--------------------------	---------------------------	-------------------------------	---------------------------	-------

- **Technique – 20 Possible Points**
 Articulation Accuracy Attacks Releases Precision

V – Poor 10.0 – 11.9	IV – Fair 12.0 – 13.9	III – Good 14.0 – 15.9	II – Excellent 16.0 – 17.9	I Superior 18.0 – 20.0	SCORE
-------------------------	--------------------------	---------------------------	-------------------------------	---------------------------	-------

- **Interpretation – 20 Possible Points**
 Style Tempi Dynamics Phrasing Traditional

V – Poor 10.0 – 11.9	IV – Fair 12.0 – 13.9	III – Good 14.0 – 15.9	II – Excellent 16.0 – 17.9	I Superior 18.0 – 20.0	SCORE
-------------------------	--------------------------	---------------------------	-------------------------------	---------------------------	-------

- **Rhythm – 20 Possible Points**
 Melodic Accuracy Accompaniment Accuracy

V – Poor 5.0 – 5.9	IV – Fair 6.0 – 6.9	III – Good 7.0 – 7.9	II – Excellent 8.0 – 8.9	I Superior 9.0 – 10.0	SCORE
-----------------------	------------------------	-------------------------	-----------------------------	--------------------------	-------

- **Balance – 10 Possible Points**
 Melodic Harmonic

V – Poor 5.0 – 5.9	IV – Fair 6.0 – 6.9	III – Good 7.0 – 7.9	II – Excellent 8.0 – 8.9	I Superior 9.0 – 10.0	SCORE
-----------------------	------------------------	-------------------------	-----------------------------	--------------------------	-------

- **Music Selection – 10 Possible Points**
 Variety Appropriateness to Ensemble

TOTAL

V – Poor 50.0 – 59.9	IV – Fair 60.0 – 69.9	III – Good 70.0 – 79.9	II – Excellent 80.0 – 89.9	I Superior 90.0 – 100.0	TOTAL SCORE
-------------------------	--------------------------	---------------------------	-------------------------------	----------------------------	-------------

Adjudicator's Signature _____ Date _____



JAZZ / STAGE BAND COMPETITION





West Virginia Strawberry Festival High School Band Jazz/Stage Competition

Date:	Friday
Time:	9:00 a.m. until 5:00 p.m.
Location:	WV Wesleyan College
Participants:	Groups will be limited to sixteen

DEFINITION: High School Jazz/Stage Band shall be such as to make it a generic term to define a group of no more than 25 high school student musicians performing music on wind instruments and percussion instruments and leg or directed without qualifying restriction by any person.

CLASSIFICATION: There will be one “Open Class”. If schedule permits, a limited number of bands may enter a second unit and it will compete in “Open Class”.

ADJUDICATION TIMES: The contest will begin at 9:00 a.m.

MUSIC: Should be of high quality, festival material rated either “Medium Difficult” or “Difficult”. Your final rating will reflect, in part, the suitability of your choice of music along with its effectiveness in showcasing the various talents of your band.

ADJUDICATION PROGRAM: Shall consist of a minimum of three selections, displaying artistry in at least two contrasting styles, (more if possible). You are encouraged to play more than three **PROVIDING** you stay well within the time limit of 30 minutes to set up, perform, and leave the performance area.

EXPLANATION: Contrasting styles refer to Swing, Ballad, Latin, Rock, etc. It does not simply imply contrast in tempo, such as fast rock, slow rock, fast swing, slow swing, etc.

TIME: Each band will be on stage for thirty (30) minutes, which includes time for setting up the stage, warm-up, performance and leaving the stage.

EQUIPMENT ON STAGE: Will include: conductor’s stand, 25 musician’s stands, 25 chairs, a P.A. System with four (4) microphones and a small grand piano. Each band must furnish its own drum set, electric piano, guitar amps, sticks, mallets, beater, and additional percussion equipment required by its repertoire and not provided as listed above.



ADJUDICATION: The WV Strawberry Festival Band Adjudication Form is to be used by Judges. A sample copy is attached. To obtain the final score for a band in competition, the score of the three judges will be averaged.

AWARDS: Awards will be presented to the bands finishing first, second, and third. Trophies will be awarded to the bands with the best “Sax” section, the best “Trumpet” section, the best “Trombone” section, the best “Rhythm” section, and the best “Soloist”.

Presentation of these awards will be made in the Virginia Thomas Law Center for the Performing Arts immediately following the conclusion of the day’s concert and jazz programs.

Sweepstakes Grand Champion Trophies will be awarded to the bands finishing first, second, and third place in the highest cumulative points scored in concert, jazz/stage, field and parade competition.

Sweepstakes Grand Champion: ONLY bands competing in all four competitions are eligible for Sweepstakes Grand Champion Awards. Presentation of awards for classification winners and Grand Champion winners will be made immediately following the adjudication of the final band in the day’s program.

ENTRY FEE: A non-refundable entry of \$125.00 is to be paid and returned with your festival application. Check should be made payable to the West Virginia Strawberry Festival.

*There is no entry fee for participation in any of the three parades.

ELIGIBILITY: Eligibility is limited to Jazz/Stage Bands from any High School accredited by its authorized state agency or accreditation organization such as the North Central Association. All bands must include the agency on the application form.

TIEBREAKER: Tied scores involving two bands eligible for awards or trophies will be broken by consultation of the Judges.

CONDUCTOR’S SCORES: Each band must provide two conductor’s scores for each of the selections submitted for adjudication. Every score must have the measures numbered consecutively. These scores will be returned at the conclusion of the event along with adjudicator’s score sheets, tape comments, and tabulator’s recap.

ADJUDICATION TIME: Entry fee must be received before adjudication time is assigned to your band. It is to your advantage that we receive your entry fee as soon as possible.



West Virginia Strawberry Festival Jazz/Stage Band Competition Program Form

Dear Band Director: The following information will be used to prepare the program for the jazz/stage band competition. Typed responses would be preferred and try to limit your information to the space allowed.

Name of School: _____

City and State: _____

Director:			
Assistant Director:			
Principal:			
Number in performing group		School Enrollment:	

Recent Honors and Activities:

MUSIC SELECTIONS

Composer/Arranger	Title	Publisher
1. _____	_____	_____
2. _____	_____	_____
3. _____	_____	_____
4. _____	_____	_____
5. _____	_____	_____



Jazz Band Adjudication

School Name _____ Class _____

Director's Name _____ Size of Band _____

V – Poor 10.0 – 11.9	IV – Fair 12.0 – 13.9	III – Good 14.0 – 15.9	II – Excellent 16.0 – 17.9	I Superior 18.0 – 20.0	SCORE
-------------------------	--------------------------	---------------------------	-------------------------------	---------------------------	-------

- **Tone Quality and Intonation – 20 Possible Points**
 Blend Harmonic Structure Control Individuals
 Melodic Line Collective Quality

V – Poor 10.0 – 11.9	IV – Fair 12.0 – 13.9	III – Good 14.0 – 15.9	II – Excellent 16.0 – 17.9	I Superior 18.0 – 20.0	SCORE
-------------------------	--------------------------	---------------------------	-------------------------------	---------------------------	-------

- **Technique – 20 Possible Points**
 Articulation Accuracy Attacks Releases Precision

V – Poor 10.0 – 11.9	IV – Fair 12.0 – 13.9	III – Good 14.0 – 15.9	II – Excellent 16.0 – 17.9	I Superior 18.0 – 20.0	SCORE
-------------------------	--------------------------	---------------------------	-------------------------------	---------------------------	-------

- **Interpretation – 20 Possible Points**
 Style Tempi Dynamics Phrasing Traditional

V – Poor 10.0 – 11.9	IV – Fair 12.0 – 13.9	III – Good 14.0 – 15.9	II – Excellent 16.0 – 17.9	I Superior 18.0 – 20.0	SCORE
-------------------------	--------------------------	---------------------------	-------------------------------	---------------------------	-------

- **Rhythm – 20 Possible Points**
 Melodic Accuracy Accompaniment Accuracy

V – Poor 5.0 – 5.9	IV – Fair 6.0 – 6.9	III – Good 7.0 – 7.9	II – Excellent 8.0 – 8.9	I Superior 9.0 – 10.0	SCORE
-----------------------	------------------------	-------------------------	-----------------------------	--------------------------	-------

- **Improvisation – 10 Possible Points**

V – Poor 5.0 – 5.9	IV – Fair 6.0 – 6.9	III – Good 7.0 – 7.9	II – Excellent 8.0 – 8.9	I Superior 9.0 – 10.0	SCORE
-----------------------	------------------------	-------------------------	-----------------------------	--------------------------	-------

- **Music Selection – 10 Possible Points**
 Variety Appropriateness to Ensemble

TOTAL

V – Poor 50.0 – 59.9	IV – Fair 60.0 – 69.9	III – Good 70.0 – 79.9	II – Excellent 80.0 – 89.9	I Superior 90.0 – 100.0	TOTAL SCORE
-------------------------	--------------------------	---------------------------	-------------------------------	----------------------------	-------------

Adjudicator's Signature _____

Date _____